

**ZEPHYR® Model
Pneumatic Retrofit Block**

VLV-CMN-219X Series

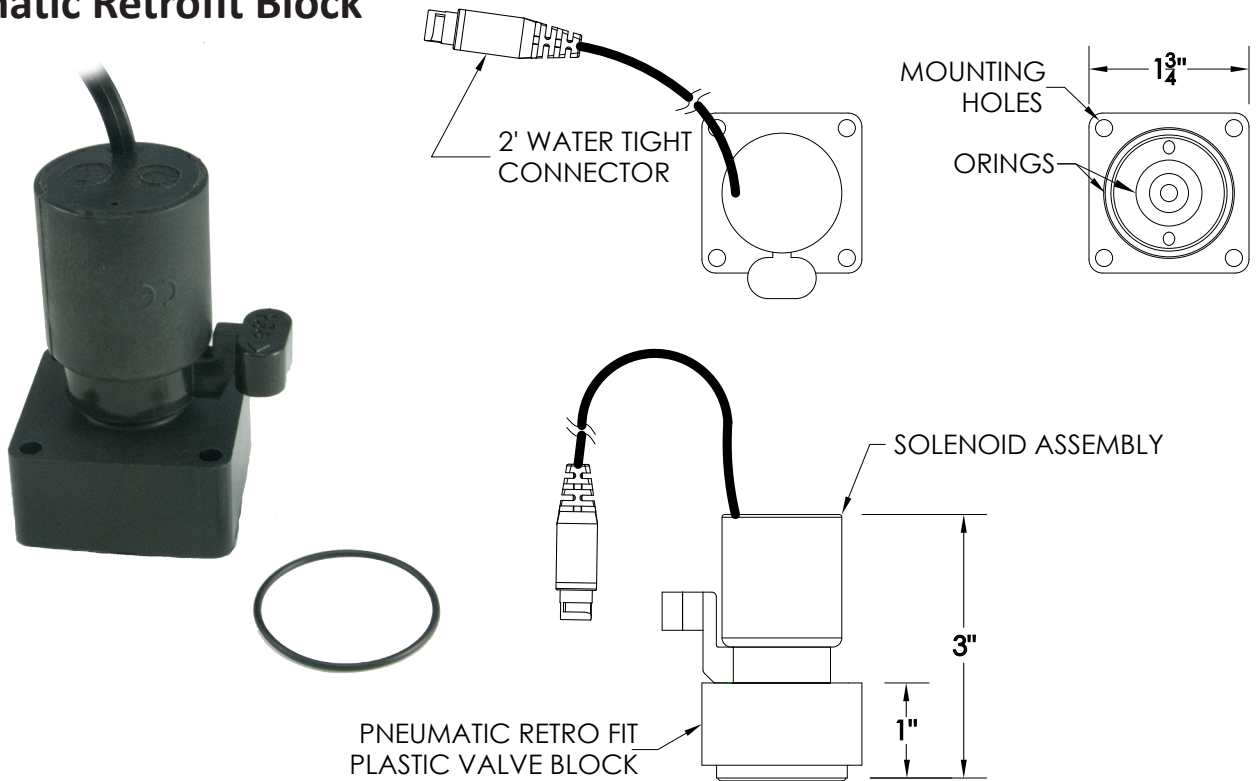

► **Description**

Pneumatic Retrofit Block easily converts existing pneumatic valves to low voltage, electronically controlled systems. The VLV-CMN-2190 replaces Acorn, Metcraft, and Willoughby pneumatic servomotors while the VLV-CMN-2191 replaces older style Bradley pneumatic servomotors.

► **Available Options** (choose one)

- 1-3/4" Block w/ 24VAC TruFIRE™ Solenoid
- 1-3/4" Block w/ 9VDC TruFIRE™ Solenoid
- 2" Block w/ 24VAC TruFIRE™ Solenoid
- 2" Block w/ 9VDC TruFIRE™ Solenoid

► **Solenoid Power** (choose one)

- 24 Volts AC
- 9 Volts DC (Battery Operated)

► **Accessories**

See Accessories Section of the I-CON catalog or contact our Customer Service Team for details.

Specifications

- Expandable valve solution allowing for one (1) pre-temperd water supply for up to five (5) shower valves
- No metering diaphragms to fail and clog
- Engineered non-metallic valve body made from Delrin for advanced corrosion resistance
- Ability to activate using manual by-pass handle
- Advanced design allows for 1.5 GPM shower saving water over 2 GPM shower units
- All solenoid are interchangeable with other I-CON valves reducing spare parts
- Maximum water temperature of 120 degrees F and maximum pressure of 100 PSI



This space is for Architect/Engineer approval

The information contained in this document is subject to change without notice.